

# HEAVY DUTY MULTIPOLE CONNECTORS



## Crimp Contacts

10A Crimp Contact



### 10A Crimp Contact

Part #	Female Crimp Contacts	OEM Part #
S22	0.14 ÷ 0.37 mm <sup>2</sup> , AWG 26 ÷ 22	CDFA 0.3
S20	0.5 mm <sup>2</sup> , AWG 20	CDFA 0.5
S18A	0.75 mm <sup>2</sup> , AWG 18	CDFA 0.7
S18B	1 mm <sup>2</sup> , AWG 18	CDFA 1.0
S16	1.5 mm <sup>2</sup> , AWG 16	CDFA 1.5
S14	2.5 mm <sup>2</sup> , AWG 14	CDFA 2.5

16A Crimp Contact



Part #	Male Crimp Contacts	OEM Part #
P22	0.14 ÷ 0.37 mm <sup>2</sup> , AWG 26 ÷ 22	CDMA 0.3
P20	0.5 mm <sup>2</sup> , AWG 20	CDMA 0.5
P18A	0.75 mm <sup>2</sup> , AWG 18	CDMA 0.7
P18B	1 mm <sup>2</sup> , AWG 18	CDMA 1.0
P16	1.5 mm <sup>2</sup> , AWG 16	CDMA 1.5
P14	2.5 mm <sup>2</sup> , AWG 14	CDMA 2.5

Use Crimp Tool "CCPZ MIL"

40A Crimp Contact



### 40A Crimp Contact

Part #	Female Crimp Contacts	OEM Part #
SS16	1.5 mm <sup>2</sup> , AWG 16	
SS14	2.5 mm <sup>2</sup> , AWG 14	CDMA 2.5
SS12	4 mm <sup>2</sup> , AWG 12	
SS10	6 mm <sup>2</sup> , AWG 10	

Part #	Male Crimp Contacts	OEM Part #
SP16	1.5 mm <sup>2</sup> , AWG 16	
SP14	2.5 mm <sup>2</sup> , AWG 14	CDMA 2.5
SP12	4 mm <sup>2</sup> , AWG 12	
SP10	6 mm <sup>2</sup> , AWG 10	

Use Crimp Tool "CXPZ D"

### 16A Crimp Contact

Part #	Female Crimp Contacts	OEM Part #
ES22	0.14 ÷ 0.37 mm <sup>2</sup> , AWG 26 ÷ 22	
ES20	0.5 mm <sup>2</sup> , AWG 20	CCFA 0.5
ES18A	0.75 mm <sup>2</sup> , AWG 18	CCFA 0.7
ES18B	1 mm <sup>2</sup> , AWG 18	CCFA 1.0
ES16	1.5 mm <sup>2</sup> , AWG 16	CCFA 1.5
ES14	2.5 mm <sup>2</sup> , AWG 14	CCFA 2.5
ES12	4 mm <sup>2</sup> , AWG 12	

Part #	Male Crimp Contacts	OEM Part #
EP22	0.14 ÷ 0.37 mm <sup>2</sup> , AWG 26 ÷ 22	
EP20	0.5 mm <sup>2</sup> , AWG 20	CCMA 0.5
EP18A	0.75 mm <sup>2</sup> , AWG 18	CCMA 0.7
EP18B	1 mm <sup>2</sup> , AWG 18	CCMA 1.0
EP16	1.5 mm <sup>2</sup> , AWG 16	CCMA 1.5
EP14	2.5 mm <sup>2</sup> , AWG 14	CCMA 2.5
EP12	4 mm <sup>2</sup> , AWG 12	

Use Crimp Tool "CCPZ MIL"

## HOW TO CONVERT HOODS & BASES FROM PG TO NPT

Change the last number in the part number as follows:

Thread size	Pg to NPT	Metric to NPT	Thread size
Pg 11 to 3/8" NPT	2 to 9	16 to 9	M16 – 3/8"
Pg 11 to 1/2" NPT	2 to 10	16 to 10	M16 – 1/2"
Pg 13.5 to 1/2" NPT	3 to 10	20 to 10	M20 – 1/2"
Pg 16 to 1/2" NPT	4 to 10	25 to 10	M25 – 1/2"
Pg 21 to 3/4" NPT	5 to 11	25 to 11	M25 – 3/4"
Pg 29 to 1" NPT	6 to 12	32 to 11	M32 – 3/4"
Pg 29 to 1-1/4" NPT	6 to 13	32 to 12	M32 – 1"
Pg 36 to 1-1/4" NPT	7 to 13	32 to 13	M32 – 1-1/4"
Pg 36 to 1-1/2" NPT	7 to 14	40 to 12	M40 – 1"
Pg 42 to 1-1/2" NPT	8 to 14	40 to 13	M40 – 1-1/4"
		50 to 14	M50 – 1-1/2"

Examples:

ES1L06S4 (Pg 16) → ES1L06S10 (1/2" NPT)

ETTP16D5 (Pg 21) → ETTP16D11 (3/4" NPT)

**CQ** 5 poles + ⊕ 16A - 230/400V



enclosures:

size "21.21"

inserts, crimp connections

16A crimp contacts  
normal and for advanced opening  
silver and gold plated

- characteristics according to EN 61984:
- 16A 230/400V 4kV 3**
- UL, CSA, CCC, GL certified
- coding pins CR Q12



description

part No.

part No.

part No.

without contacts (to be ordered separately)  
female inserts for female contacts  
male inserts for male contacts

**CQF 05**  
**CQM 05**

16A female contacts

0.5 mm <sup>2</sup>	AWG 20	with no grooves
0.75 mm <sup>2</sup>	AWG 18	one groove (back side)
1 mm <sup>2</sup>	AWG 18	one groove
1.5 mm <sup>2</sup>	AWG 16	two grooves
2.5 mm <sup>2</sup>	AWG 14	three grooves
3 mm <sup>2</sup>	AWG 12	one wide groove
4 mm <sup>2</sup>	AWG 12	with no grooves

16A male contacts

0.5 mm <sup>2</sup>	AWG 20	with no grooves
0.75 mm <sup>2</sup>	AWG 18	one groove (back side)
1 mm <sup>2</sup>	AWG 18	one groove
1.5 mm <sup>2</sup>	AWG 16	two grooves
2.5 mm <sup>2</sup>	AWG 14	three grooves
3 mm <sup>2</sup>	AWG 12	one wide groove
4 mm <sup>2</sup>	AWG 12	with no grooves

16A male crimp contacts for advanced opening

0.5 mm <sup>2</sup>	AWG 20	with no grooves
0.75 mm <sup>2</sup>	AWG 18	one groove (back side)
1 mm <sup>2</sup>	AWG 18	one groove
1.5 mm <sup>2</sup>	AWG 16	two grooves
2.5 mm <sup>2</sup>	AWG 14	three grooves

**CCFA 0.5**  
**CCFA 0.7**  
**CCFA 1.0**  
**CCFA 1.5**  
**CCFA 2.5**  
**CCFA 3.0**  
**CCFA 4.0**

silver plated

**CCFD 0.5**  
**CCFD 0.7**  
**CCFD 1.0**  
**CCFD 1.5**  
**CCFD 2.5**  
**CCFD 3.0**  
**CCFD 4.0**

gold plated

**CCMA 0.5**  
**CCMA 0.7**  
**CCMA 1.0**  
**CCMA 1.5**  
**CCMA 2.5**  
**CCMA 3.0**  
**CCMA 4.0**

**CCMD 0.5**  
**CCMD 0.7**  
**CCMD 1.0**  
**CCMD 1.5**  
**CCMD 2.5**  
**CCMD 3.0**  
**CCMD 4.0**

**CC 0.5 AN**  
**CC 0.7 AN**  
**CC 1.0 AN**  
**CC 1.5 AN**  
**CC 2.5 AN**

**N.B.:**

can also be used partially fitted with 4 mm<sup>2</sup> section contacts.

plug inserts with new, square shaped seal for IP44 and IP66/IP67 protection rating

dimensions in mm

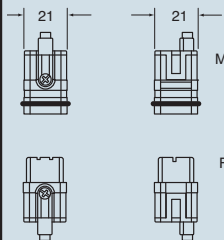

contacts side (front view)

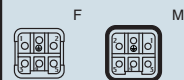

dimensions in mm

**CCF and CCM**

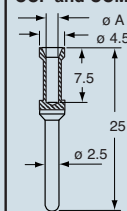

**CC...AN**

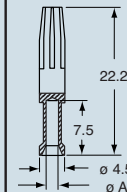
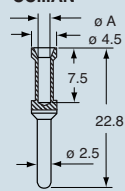

**CCF, CCM and CC...AN contacts**

conductor section mm <sup>2</sup>	ø slot A (mm)
0.5	1.1
0.75	1.3
1.0	1.45
1.5	1.8
2.5	2.2
3	2.55
4	2.85

dimensions shown are not binding and may be changed without notice