

DO SERIES
PART # : DO _ _ _ _ YZ

ELECTRICAL SPECIFICATIONS

SERIES DO

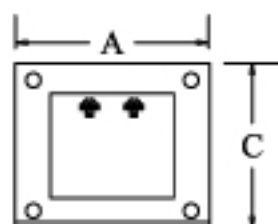
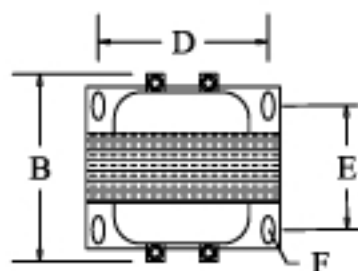

TYPE OUVERT/OPEN TYPE
BORNE À VIS / SCREW LUG

- * 25VA@1000VA
- ** 1500VA@6000VA
- PHASE: 1
- FREQ.: 50/60 Hz.
***60 Hz.
- INSUL. CLASS *B(130°C)
**H(180°C)
- TEMP. RISE * < 80°C
** < 120°C
- SOUND LEVEL < 40 dB.

YZ / VOLTAGE

- A = 12
- B = 24
- C = 12/24
- D = 16/32
- E = 120
- F = 208
- G = 240
- H = 120/240
- I = 277
- U = 480/600***
- J = 347
- K = 380
- L = 347/380
- M = 416
- N = 208/416
- O = 480***
- P = 240/480
- Q = 600***
- S = _____

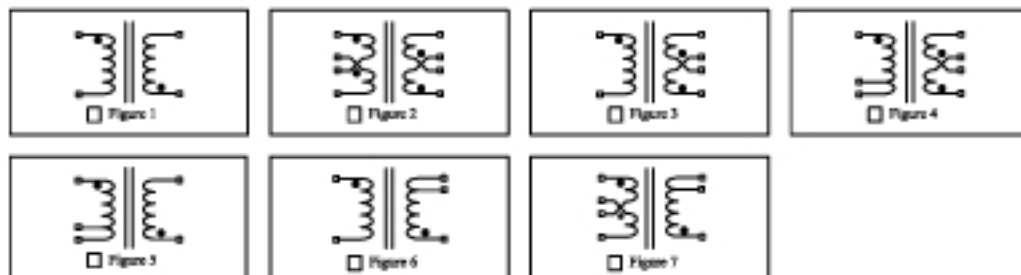

MECHANICAL SPECIFICATIONS: (dimensions = inches).

VA	0025	0050	0100	0150	0200	0250	0350	0500	0750	1000	1500	2000	2500	3000	4000	5000	6000
A	3.00	3.00	3.75	3.75	3.75	4.50	4.50	5.25	5.25	5.25	7.50	7.50	9.00	9.00	9.00	9.00	9.00
B	3.07	3.30	3.75	4.22	4.80	4.50	5.35	5.25	6.45	6.80	6.00	7.00	7.25	7.25	8.25	9.25	10.3
C	2.58	2.58	3.20	3.20	3.20	3.83	3.83	4.44	4.44	4.44	6.38	6.38	7.75	7.75	7.75	7.75	7.75
D MTG	2.50	2.50	3.14	3.13	3.13	3.75	3.75	4.38	4.38	4.38	6.75	6.75	6.98	6.98	6.98	6.98	6.98
E MTG	2.25	2.25	1.90	2.48	3.12	2.73	3.73	3.10	4.10	5.10	3.50	4.50	4.76	4.76	5.76	6.76	7.76
F MTG	0.22*0.63		0.2*0.4	0.22*0.63			0.28*0.63			0.31*0.68			0.40*0.62				
LBS	1.60	2.30	3.70	4.40	5.80	7.40	11.8	12.9	18.4	24.2	27.7	40.4	59.8	59.8	78.4	94.3	113
KG	0.73	1.04	1.68	2.00	2.63	3.36	5.35	5.85	8.35	11.0	12.5	18.3	27.1	27.1	35.5	42.7	51.1

All dimensions and weights are approximate. Specifications may change without notice.

ZONE	REV	REVISION	DESCRIPTION	DATE	APPROVAL

Dessiné par / Drawn by: SS

MODEL NUMBER:
DO _ _ _ _ YZ

DWG NO. 71CUD0R5

PAGE: 1 de 1