

LIQUIDTIGHT CONNECTORS



LIQUA-SEAL® LIQUIDTIGHT CONNECTORS

The family of Remke Liqua-Seal Connectors are available in three different styles: L-Series in zinc-plated steel or zinc-plated malleable iron or die cast zinc; ALM-Series of aluminum liquidtight connectors; and the LL-Series of stainless steel liquidtight connectors.

With multiple sizes and material options including steel, stainless steel, aluminum and zinc-plated malleable iron, the Tuff-Seal family of Liqua-Seal® Liquidtight Connectors feature IP65, IP68 and NEMA 4X ratings and are suitable for use in Class I, Div II locations. They are ideally suited for OEM applications that require flexibility & protection against entry of vapors, liquids or solids including

- Food Processing Plants
- Petroleum Machinery
- Chemical Processing
- Offshore Rights
- Machine Shop Equipment
- Pulp & Paper Factories
- Automation Equipment
- Heavy-Duty Electrical Motor Housings
- Machine Tool Building
- Robotics Assembly
- Motor & Transformer Terminations

OTHER CONDUIT & CONNECTORS



LIQUIDTIGHT CONNECTORS



L SERIES LIQUA-SEAL® CONNECTORS

L-Series Liqua-Seal Connectors are made of steel with a chromium zinc plating on the body, ferrule, locknut and clamp nut to prevent corrosion under the most adverse of conditions. Rated IP65, these connectors are UL Listed & CSA Certified with a watertight and oiltight design that provides strain relief and reduces stress on components and termination points. L-Series connectors are available in straight, 90° and 45° body styles and are also available with insulated throats and wire mesh grips. Die-cast zinc versions are also available.

L-Series Liqua-Seal Connectors are ideally suited for use in applications such as food processing plants, chemical processing facilities, offshore rigs, pulp and paper factories, automation equipment, heavy-duty electrical motor housings and medical equipment

Notes

Dimensional information on page 7 in Tuff-Seal Technical Reference

KNOCKOUT DIMENSIONS

N.P.T. Hub Size	Knockout Hole Recommended (Min to Max/ Inches)
1/4"	.540 to .570
3/8"	.671 to .701
1/2"	.859 to .906
3/4"	1.094 to 1.141
1"	1.359 to 1.406
1 1/4"	1.719 to 1.766
1 1/2"	1.969 to 2.016
2"	2.453 to 2.500
2 1/2"	2.953 to 3.000
3"	3.578 to 3.625
3 1/2"	3.570 TO 4.040
4"	4.550 TO 4.630

ZINC-PLATED STEEL, STRAIGHT, EXTERNAL CONDUIT THREAD

PART NUMBERS

Conduit Size	Standard	Insulated Throat	With Mesh Grip	Insulated With Mesh Grip	Mesh Length
3/8"	LMM-01	LMM-02	LMM-01-E	LMM-02-E	2 5/8"
1/2"	LMM-11	LMM-12	LMM-11-E	LMM-12-E	3 7/8"
3/4"	LMM-21	LMM-22	LMM-21-E	LMM-22-E	4 3/8"
1"	LMM-31	LMM-32	LMM-31-E	LMM-32-E	5 1/4"
1 1/4"	LMM-41	LMM-42	LMM-41-E	LMM-42-E	5 5/8"
1 1/2"	LMM-51	LMM-52	LMM-51-E	LMM-52-E	5 3/4"
2"	LMM-61	LMM-62	LMM-61-E	LMM-62-E	7 1/2"
2 1/2"	LMM-71	LMM-72	—	—	—
3"	LMM-81	LMM-82	—	—	—
3 1/2"	LMM-91	LMM-92	—	—	—
4"	LMM-101	LMM-102	—	—	—

ZINC-PLATED MALLEABLE IRON, 45°, EXTERNAL CONDUIT THREAD

PART NUMBERS

Conduit Size	Standard	Insulated Throat	With Mesh Grip	Insulated With Mesh Grip	Mesh Length
3/8"	LMA-01	LMA-02	LMA-01-E	LMA-02-E	2 5/8"
1/2"	LMA-11	LMA-12	LMA-11-E	LMA-12-E	3 7/8"
3/4"	LMA-21	LMA-22	LMA-21-E	LMA-22-E	4 3/8"
1"	LMA-31	LMA-32	LMA-31-E	LMA-32-E	5 1/4"
1 1/4"	LMA-41	LMA-42	LMA-41-E	LMA-42-E	5 5/8"
1 1/2"	LMA-51	LMA-52	LMA-51-E	LMA-52-E	5 3/4"
2"	LMA-61	LMA-62	LMA-61-E	LMA-62-E	7 1/2"

ZINC-PLATED MALLEABLE IRON, 90°, EXTERNAL CONDUIT THREAD

PART NUMBERS

Conduit Size	Standard	Insulated Throat	With Mesh Grip	Insulated With Mesh Grip	Mesh Length
3/8"	LML-01	LML-02	LML-01-E	LML-02-E	2 5/8"
1/2"	LML-11	LML-12	LML-11-E	LML-12-E	3 7/8"
3/4"	LML-21	LML-22	LML-21-E	LML-22-E	4 3/8"
1"	LML-31	LML-32	LML-31-E	LML-32-E	5 1/4"
1 1/4"	LML-41	LML-42	LML-41-E	LML-42-E	5 5/8"
1 1/2"	LML-51	LML-52	LML-51-E	LML-52-E	5 3/4"
2"	LML-61	LML-62	LML-61-E	LML-62-E	7 1/2"
2 1/2"	LML-71	LML-72	—	—	—
3"	LML-81	LML-82	—	—	—
3 1/2"	LML-91	LML-92	—	—	—
4"	LML-101	LML-102	—	—	—

DIE-CAST ZINC

PART NUMBERS

Conduit Size	Straight Connector	90° Connector
3/8"	LTM-38	LTM-9038
1/2"	LTM-50	LTM-9050
3/4"	LTM-75	LTM-9075
1"	LTM-100	LTM-90100
1-1/4"	LTM-125	LTM-90125
1-1/2"	LTM-150	LTM-90150
2"	LTM-200	LTM-90200

Notes

Rated for Type B Conduit - Metallic & Non-Metallic





STAINLESS STEEL LIQUIDTIGHT CONNECTORS

Rated IP68 and NEMA 4X, Remke Stainless Steel Liquidtight Connectors offer all the corrosion resistance you need AND the strength of stainless steel for the highest levels of endurance. Additional features of these connectors include:

- Used to connect liquidtight conduit into a knockout or threaded NPT opening
- For use in wet or dry locations to seal electrical connections against dust, dirt, oil, water, chemicals and other corrosive elements
- Type 304 stainless steel body and ferrule
- Available in straight and 90 degree, 3/8" to 2" in stock
- Nylon insulated throat
- Viton® O-Ring standard (optional from other manufacturers)

Remke Stainless Steel Liquidtight Connectors are ideally suited for OEM and MRO applications known for their corrosive and abusive environments including:

- Food & Beverage Processing
- Petrochemical
- Pulp & Paper Mills
- Wastewater Treatment
- Heavy-duty electrical motors, generators and transformers
- Offshore Oil Rigs & Platforms
- Chemical Processing
- Portable equipment
- Machine Tool Building

KNOCKOUT DIMENSIONS

N.P.T. Hub Size	Knockout Hole Recommended (Min to Max/ Inches)
1/4"	.540 to .570
3/8"	.671 to .701
1/2"	.859 to .906
3/4"	1.094 to 1.141
1"	1.359 to 1.406
1 1/4"	1.719 to 1.766
1 1/2"	1.969 to 2.016
2"	2.453 to 2.500
2 1/2"	2.953 to 3.000
3"	3.578 to 3.625
3 1/2"	3.570 TO 4.040
4"	4.550 TO 4.630



STRAIGHT STAINLESS STEEL LIQUIDTIGHT CONNECTORS

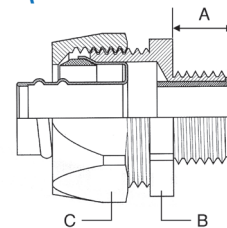

PART NUMBERS

Conduit Size	Catalog Number	Thread Length (A)	Body Hex (B)	Dia. Across Flats (C)
3/8"	LMSS-01	0.45	0.94	1.02
1/2"	LMSS-11	0.51	1.06	1.14
3/4"	LMSS-21	0.59	1.30	1.38
1"	LMSS-31	0.59	1.69	1.77
1 1/4"	LMSS-41	0.63	2.04	2.12
1 1/2"	LMSS-51	0.71	2.36	2.44
2"	LMSS-61	0.79	2.93	3.03

90 DEGREE STAINLESS STEEL LIQUIDTIGHT CONNECTORS

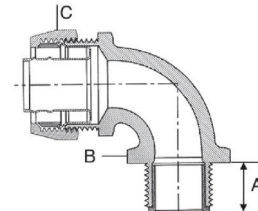
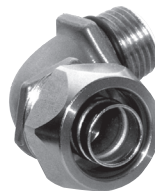

PART NUMBERS

Conduit Size	Catalog Number	Thread Length (A)	Body Hex (B)	Dia. Across Flats (C)
3/8"	LMSS-01-90	0.45	0.94	1.02
1/2"	LMSS-11-90	0.51	1.06	1.14
3/4"	LMSS-21-90	0.59	1.30	1.38
1"	LMSS-31-90	0.59	1.69	1.77
1 1/4"	LMSS-41-90	0.63	2.04	2.12
1 1/2"	LMSS-51-90	0.71	2.36	2.44
2"	LMSS-61-90	0.79	2.93	3.03

SPECIFICATIONS

MATERIALS

Body and Cap	304 Stainless Steel
Ferrule	304 Stainless Steel
O-Ring	Viton®
Protection	IP68, NEMA 4X
Listings	UL Listed, CSA Certified RoHS Compliant

LIQUID TIGHT CONDUIT AND TUBING

LIQUID TIGHT CONDUIT



FTPV (Type B)

- Intended for use as a raceway for the installation of approved conductors with a nominal rating of 600 volts or less for non-hazardous locations
- Sizes from 3/8" to 2"
- Integral Rigid and Flexible PVC Construction resists Pull and Crushing. Suitable for Indoor or Outdoor use.
- Sunlight resistant
- Temperature Ratings:
Dry 0° to 176°F (-18 to 80°C)
In Oil. Up to 160°F (70°C)
Wet Locations . . . Up to 140°F (60°C)
- Use Straight-Thru and Right-Angle Conduit Connectors
- Cut to Length with WT-1 Cutting Tool
- Cannot run mix of wire voltages in conduit



Listed
7B07
E129973



Approved
LL-84705



700816
20817

Grey Part #	Trade Size	UL/CSA Desc.	A Outside Diameter (Inch)	B Inside Diameter (Inch)	Quantity
FTPV3758C	3/8	HF1 3/8	0.7	0.494	Stocked in 100 Foot Rolls
FTPV5008C	1/2	HF1 1/2	0.83	0.632	
FTPV7508C	3/4	HF1 3/4	1.04	0.830	
FTPV10008C	1	HF1 1	1.303	1.054	
FTPV12508C	1-1/4	EC125	1.66	1.410	50 Ft
FTPV15008L	1-1/2	EC150	1.9	1.600	
FTPV20008L	2	EC200	2.375	2.045	

Use CCNY-XXX-8 or NMSC-XXX-8 connectors on page 5.



WT-1 Cutting Tool

NON-METALLIC ELECTRICAL TUBING*



(May be used outdoors)

TUPV (Type B)

- Intended for use as a support and protection of insulated conductors with a nominal rating of 600 volts or less in equipment for non-hazardous locations
- TUPV 0°F to 176°F (-18°C to 80°C) temperature rating
- Maximum flexibility tubing can be used in extremely tight quarters
- Smooth inside for easier wire pulling
- Suitable for high vibration or flexing applications
- Black
- CSA approved as liquid-tight tubing only
- Not CSA approved for mechanical protection – not considered conduit
- Cannot run mix of wire voltages in tubing



E129972



20817



Grey Part #	Trade Size	UL/CSA Desc.	A Outside Diameter (Inch)	B Inside Diameter (Inch)	Quantity
*TUPV2500C	1/4	ET025	0.575	0.405	100
TUPV3750C	3/8	ET038	0.71	0.504	100
TUPV5000C	1/2	ET050	0.84	0.642	100
TUPV7500C	3/4	ET075	1.05	0.84	100
TUPV10000C	1	ET100	1.315	1.066	100
TUPV12500C	1-1/4	ET125	1.66	1.41	100
TUPV15000L	1-1/2	ET150	1.9	1.6	50
TUPV20000L	2	ET200	2.375	2.045	50

Use CCNY-XXX-0 connector on page 5.

*Not Approved by CSA or 

LIQUID TIGHT CONNECTORS - NYLON/PVC

Straight and Right Angle Non-Metallic Connectors

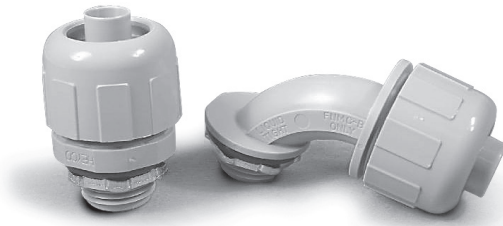

Straight Connector

- UV rated
- Four Sizes for 3/8" to 2" Conduit
- No Disassembly Required to Install. Simply push Conduit or Tubing over Ferrule and tighten Sealing Nut
- No Threading of Conduit is Necessary. Lower your Installed Cost
- Connector may be reused. Turn Sealing Nut in Clockwise direction to Release Conduit
- Molded 6/6 Nylon. Non-Conductive, Non-Corrosive; Resistant to Fuels, Lubricants and most Chemicals

Black Connector with 'O' Ring & Steel Locknut Part #	Grey Connector with 'O' Ring & Steel Locknut Part #	For Conduit	N.P.T. Hub Size	Knockout Hole Recommended (Min. to Max. Inches)	CTN/PKG	STD PK
CCNY2500		1/4	1/4 NPT	.540 - .570	25	100
CCNY3750	CCNY3758	3/8	1/2 NPT	.859 - .906	25	100
CCNY5000	CCNY5008	1/2	1/2 NPT	.859 - .906	25	100
CCNY7500	CCNY7508	3/4	3/4 NPT	1.094 - 1.141	10	100
CCNY10000	CCNY10008	1	1 NPT	1.359 - 1.406	5	50
CCNY12500	CCNY12508	1-1/4	1-1/4 NPT	1.719 - 1.766	5	25
CCNY15000	CCNY15008	1-1/2	1-1/2 NPT	1.969 - 2.016	2	10
CCNY20000	CCNY20008	2	2 NPT	2.453 - 2.500	2	10

90° Connector

Black Part #	Grey Part #	For Conduit	N.P.T. Hub Size	Knockout Hole Recommended (Min. to Max. Inches)	CTN/PKG	STD PK
CCNY37900	CCNY37908	3/8	1/2 NPT	.859 - .906	10	100
CCNY50900	CCNY50908	1/2	1/2 NPT	.859 - .906	10	100
CCNY75900	CCNY75908	3/4	3/4 NPT	1.094 - 1.141	10	100
CCNY10900	CCNY10908	1	1 NPT	1.359 - 1.406	5	50
CCNY125900	CCNY125908	1-1/4	1-1/4 NPT	1.719 - 1.766	5	25
CCNY150900	CCNY150908	1-1/2	1-1/2 NPT	1.969 - 2.016	2	10

Combination Straight – 90° Swivel Connector

**One connector does every angle !!



Grey Part #	For Conduit	N.P.T. Hub Size	Knockout Hole Recommended (Min. to Max. Inches)	QTY/ BOX
CCSW5008	N.M. Swivel L.T. Con. 1/2" GREY	1/2 NPT	.859 - .906	10
CCSW7508	N.M. Swivel L.T. Con. 3/4" GREY	3/4 NPT	1.094 - 1.141	10
	SCREW-ON PVC RUBBER O-RING			



Screw-On Straight and 90° Non-Metallic Connectors

For use with non-metallic liquid-tight conduit, type B.
Produced from UV rated plastic for long outdoor life.



Straight Grey Connector with 'O' Ring & Steel Locknut Part #	90° Grey Connector with 'O' Ring & Steel Locknut Part #	For Conduit	N.P.T. Hub Size	Knockout Hole Recommended (Min. to Max. Inches)	STD PK
NMSC50	NMSC9050	1/2	1/2 NPT	.859 - .906	100
NMSC75	NMSC9075	3/4	3/4 NPT	1.094 - 1.141	100





WH SERIES CONDUIT HUBS

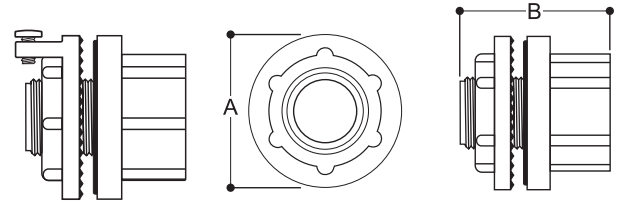

DIE CAST ZINC

PART NUMBERS					
Hub Size	Zinc Die Cast	Grounded	A	B	Mtg. Hole (minimum)
1/2"	WH-1	WH-1-G	1.54	1.31	0.84
3/4"	WH-2	WH-2-G	1.73	1.37	1.05
1"	WH-3	WH-3-G	2.04	1.59	1.31
1 1/4"	WH-4	WH-4-G	2.42	1.59	1.66
1 1/2"	WH-5	WH-5-G	2.79	1.59	1.90
2"	WH-6	WH-6-G	3.30	1.59	2.37
2 1/2"	WH-7	WH-7-G	3.70	2.47	2.88
3"	WH-8	WH-8-G	4.39	2.47	3.50
3 1/2"	WH-9	—	4.81	2.69	4.11
4"	WH-10	—	5.38	2.69	4.63

WH SERIES WATERTIGHT CONDUIT HUBS

The Tuff-Seal™ WH Series of Watertight Conduit Hubs feature a design with unique angled serrations that provide a larger & tighter surface plus a reliable watertight seal even with rough or oversized knock-out. Used to connect rigid metal conduit (or IMC) to a threadless opening in electrical enclosures, Remke Conduit Hubs are rated NEMA 4 and may be used in either wet or dry applications.

Remke Watertight Conduit Hubs are available in 1/2" to 4" hub sizes in these materials:

- Die Cast Zinc – high strength & hardness with outstanding corrosion resistance

Designed with simple 2-piece construction, Remke WH Series Hubs offer positive grounding, protective insulated throats that prevent wire abrasion and an embedded O-Ring to ensure a watertight seal. A grounded style is also available.





TUFF-SEAL™ TECHNICAL REFERENCE SECTION

RoHS STATEMENT

Remke Industries supports the European Union's efforts to remove harmful chemicals from electrical products. In compliance with Directive 2011/65/EU of the European Parliament and the Council of the European Union regarding the restriction of the use of certain hazardous substances in electrical and electronic equipment (RoHS), Remke Industries certifies either:

1. The maximum concentration values of weight in homogenous materials for the substances referred to in Article 4(1) of directive 2002/95/EC that are contained in the Products do not exceed the maximum concentration values of 0.1% in respect of lead, mercury, hexavalent chromium, polybrominated biphenyls, polybrominated diphenyl ethers, and 0.01% in respect of cadmium. OR
2. The product supplied is exempt from this directive.

Remke Industries certifies that all products of our manufacture are fully compliant to the current RoHS Directive.

ISO CERTIFICATION



On July 1st, 2003 Remke Industries received ISO 9001 : 2000 certification which certifies that Remke is compliant with current ISO standards.

KNOCKOUT DIMENSIONS

N.P.T. Hub Size	Knockout Hole Recommended (Min to Max/ Inches)
1/4"	.540 to .570
3/8"	.671 to .701
1/2"	.859 to .906
3/4"	1.094 to 1.141
1"	1.359 to 1.406
1 1/4"	1.719 to 1.766
1 1/2"	1.969 to 2.016
2"	2.453 to 2.500
2 1/2"	2.953 to 3.000
3"	3.578 to 3.625
3 1/2"	3.570 TO 4.040
4"	4.550 TO 4.630

OPERATING TEMPERATURES

Material	Temperature range
Aluminum	-40°F to +300°F (-40°C to +149°C)
Buna-N	-40°F to +250°F (-40°C to +121°C)
Nylon	-40°F to +225°F (-40°C to +107°C)
Steel	-60°F to +1000°F (-51°C to +537°C)
Stainless Steel	-60°F to +1000°F (-51°C to +537°C)
Neoprene (bushings)	-40°F to +250°F (-40°C to +121°C)
Silicone (bushings)	-150°F to + 390°F (-101°C to +199°C)
Valox	-40°F to +250°F (-40°C to +121°C)
Dome-Cap Connectors:	
Non-Metallic	-22°F to +176°F (-30°C to +80°C)
Metallic	-40°F to +212°F (-40°C to +100°C)

FLAMMABILITY

Component	Rating
Mesh Grip	UL 94HB
Fitting	UL 94V-2
Note: Non-metallic cord connectors will not support combustion.	







APPROVALS, CERTIFICATION & COMPLIANCES

AGENCY	FILE NUMBER	PRODUCT OR COMPONENT
Underwriters Laboratories Inc. (UL)	E53599	RSR Series (Straight, 90°, 45°) RSP Series (Straight, 90°) RSM Cord Grips RSRs Cord Grips RSRF Series
	E52002	Liqua-Seal Connectors
	E52002(N)	WH Series Watertight Conduit Hubs
	E157356(N)	WH Series Watertight Conduit Hubs
Canadian Standards Association (CSA)	28985	RSR Series (Straight, 90°, 45°) RSP Series (Straight, 90°) RSRS Cord Grips RSRF Series RSSS Series RSPV Series RTK Series MC Cable Connectors Watertight Conduit Hubs
National Electrical Code (NEC)	Articles 400-10	RSR Series (Straight, 90°, 45°)
	Articles 400-14	RSP Series (Straight, 90°) RSM Cord Grips RSRS Cord Grips RSRF Series
	Articles 501-4(B)	WH Series Watertight Conduit Hubs
	Articles 502-4(A)	WH Series Watertight Conduit Hubs
	Articles 503-3(A)	WH Series Watertight Conduit Hubs
ROHS & WEE	All Tuff-Seal and Tuff-Link Products are Compliant	

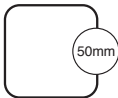
HAZARDOUS LOCATIONS

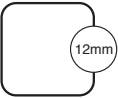
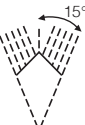
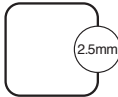
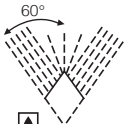
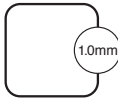
Definition	Remke Products
The Remke products listed are suitable for use in hazardous locations per Class I, Div. 2, Class II, Div 1 & 2, and Class III, Div. 1 & 2	RSR Series (Straight, 90°, 45°) WH Series Watertight Conduit Hubs RSP Series (Straight, 90°) RSM Cord Grips, RSRS Cord Grips RSRF Series

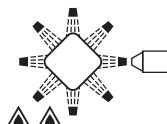
RATINGS/MATERIAL OF CONSTRUCTION						
MATERIAL	IP 54 AND NEMA 3	IP 54 AND NEMA 3R	IP65 AND NEMA 4	IP 56 AND NEMA 4X	IP67 AND NEMA 6	IP 52 AND NEMA 12
Aluminum	X	X	X	—	X	X
Nickel-Plated Aluminum	X	X	X	X	X	X
Steel	X	X	X	—	X	X
Stainless Steel	X	X	X	X	X	X
Nylon	X	X	X	—	X	X
Valox	X	X	X	X	X	X

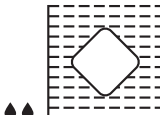
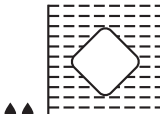
IP RATINGS DEFINITION					
First Digit	Protection From Solid Objects		Second Digit	Protection From Moisture	
0	Non-Protected		0	Non-Protected	
1		Protected against solid objects over 50mm e.g. hands, large tools	1		Protection against vertically falling drops of water
2		Protected against solid objects over 12mm e.g. hands, large tools	2		Protection against direct sprays of water up to a 15° angle
3		Protection from entry by solid objects over 2.5mm e.g. wire or small tools	3		Protection against direct sprays of water up to a 60° angle
4		Protection from entry by solid objects over 1.0mm e.g. wires or tools	4		Protection against water sprayed from any direction. Limited ingress permitted.
5		Protection against deposits of dust e.g. against equipment damage due to deposits	5		Protection against low pressure water jets from any direction. Limited ingress permitted
6		Total protection against dust ingress e.g. Dust-Tight	6		Protection against high pressure water jets from any direction. Limited ingress permitted.
IP CODE EXAMPLE			7		Protection against immersion between 15cm and 1M
IP54 = IP (IP LETTER CODE), 5 (1st Digit), 4 (2nd Digit)			8		Protection against complete and continuous immersion in water under pressure e.g. Water-Tight

RSRF SERIES CORD GRIP DIMENSIONS

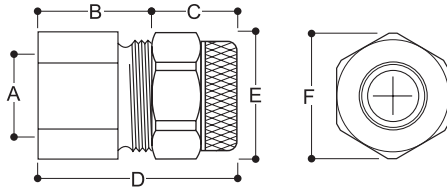

SPECIFICATIONS

Conduit Size	A Body Bore	B	C	D	E Body Hex	F Nut
3/8"	0.44	0.62	0.75	1.38	0.88	0.99
1/2"	0.62	0.69	1.06	1.75	1.12	1.33
3/4"	0.63	0.81	1.00	1.81	1.31	1.33
1"	0.94	0.94	1.31	2.25	1.63	1.70
1 1/4"	1.44	1.06	1.69	2.75	2.25	2.55
1 1/2"	1.44	1.06	1.69	2.75	2.25	2.55
2"	1.88	1.25	2.38	3.63	2.75	3.25

NOTE: Dimensions for the RSRH Hub Style Cord Grips are the same as above except for the addition of the nipple.

RSP AND RSPV STRAIGHT CORD GRIPS DIMENSIONS

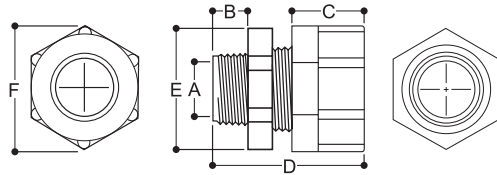

SPECIFICATIONS

Conduit Size	A Body Bore	B	C	D	E Body Hex	F Nut
3/8"	0.44	0.49	0.70	1.63	0.94	0.94
1/2"	0.57	0.50	0.88	2.01	1.12	1.25
3/4"	0.76	0.56	0.88	2.10	1.38	1.50

Dimension A is the minimum Body Bore. Other dimensions are nominal.

Dimension D is with the Nut snug but bushing uncompressed.

Dimension E is across the Straight Body hex. flats. Dimension F is across Nut hex. flats.

Dimensions are approximate.

LIQUA-SEAL CONNECTOR DIMENSIONS

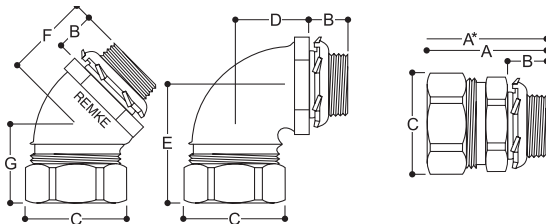

SPECIFICATIONS

Conduit Size	Hub Size	A	A*	B	C Flats	C Corners	D	E	F	G
3/8"	1/2"	1.47	4.47	0.50	1.00	1.10	1.37	1.58	0.84	1.26
1/2"	1/2"	1.47	4.97	0.50	1.13	1.23	1.37	1.75	0.87	1.47
3/4"	3/4"	1.54	5.54	0.56	1.38	1.52	1.53	1.91	0.95	1.55
1"	1"	1.96	6.96	0.64	1.63	1.80	1.81	2.23	1.10	1.81
1 1/4"	1 1/4"	2.09	8.09	0.72	2.25	2.41	2.05	2.33	1.35	1.84
1 1/2"	1 1/2"	2.09	8.84	0.72	2.50	2.68	2.18	2.46	1.43	1.90
2"	2"	2.16	10.16	0.78	3.00	3.21	2.51	2.73	1.53	2.00

NOTE: Nominal Dimensions in Inches. A* Dimension is overall length of connector with wire mesh grip. Larger sizes are available. Contact factory.

THREAD SPECIFICATIONS

PG THREAD SPECIFICATIONS		
Thread Size	Major Diameter (mm)	Pitch (mm)
Pg 7	12.5	1.27
Pg 9	15.2	1.41
Pg 11	18.6	1.41
Pg 13.5	20.4	1.41
Pg 16	22.5	1.41
Pg 21	28.3	1.56
Pg 29	37.0	1.56
Pg 36	47.0	1.56
Pg 42	54.0	1.56
Pg 48	59.3	1.56

NPT THREAD SPECIFICATIONS		
Thread Size	Major Diameter (mm)	Pitch (mm)
NPT 1/4"	13.7	1.41
NPT 3/8"	17.1	1.41
NPT 1/2"	21.3	1.81
NPT 3/4"	26.7	1.81
NPT 1"	33.4	2.21
NPT 1-1/4"	48.3	2.21
NPT 1-1/2"	47.0	2.21
NPT 2"	60.3	2.21

METRIC THREAD SPECIFICATIONS		
Thread Size	Major Diameter (mm)	Pitch (mm)
M12 X 1.5	12	1.50
M16 X 1.5	16	1.50
M20 X 1.5	20	1.50
M25 X 1.5	25	1.50
M32 X 1.5	32	1.50
M40 X 1.5	40	1.50
M50 X 1.5	50	1.50
M63 X 1.5	63	1.50

90 Degree Connectors Zinc Die Cast

- Used with locknut to terminate steel or aluminum flexible metal conduit and armored cable to enclosure to form a 90° bend.
- Assembled with die cast locknut and tri-combo screws.
- Cast from high strength zinc alloy.



Part Number	Trade Size		
K-ASQ-037 §	3/8"		

§ 3/8" size fits 1/2" knockout

Certifications

UL File No. E155411, ASQ-037 also listed for use with 14-2 through 10-3 armored cable.
CSA File No. LR57925

Saddle Clamp Connectors

- Used with locknut to terminate steel or aluminum flexible metal conduit and armored cable to enclosure.
- Assembled with die cast locknut and tri-combo screws.
- For additional listings refer to the metal clad cable and non-metallic cable sections.
- Die cast from high strength zinc alloy.

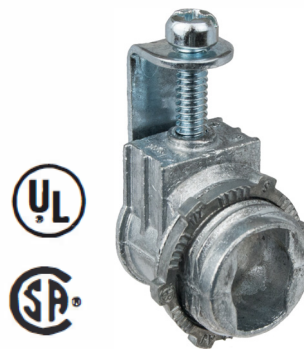

Technical Data

Part Number	Trade Size	Shipping Qty. - Bulk	Shipping Wt. (lbs)
K-SAD-037 *	3/8"		

* 3/8" size fits 1/2" knockout

Min. Cable Size	Max. Cable Size

Certifications

UL File No. E155411
CSA File No. LR57925