

Bronze Eyebolt Connectors

Types LD and LDN

- Manufactured from high strength copper alloy
- Designed to secure copper cable to flat studs, transformer spades, or copper bus
- Furnished with silicon bronze hardware for corrosion resistance
- Single wrench installation
- For tin plating, suffix catalog number with “-TN”

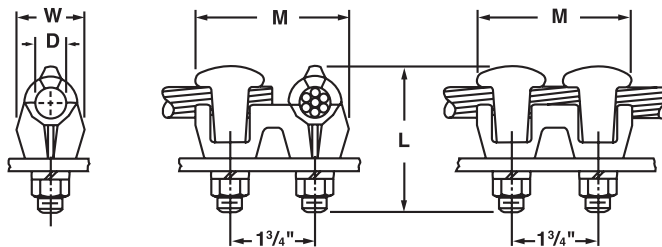
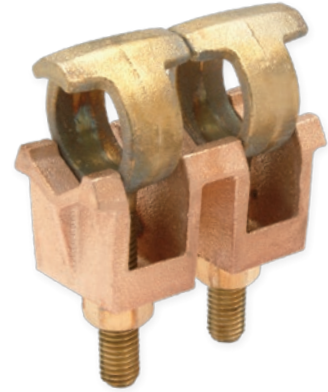

Fig. 1

Fig. 2

For 1/4" Thick Bar

CATALOG NUMBER	FIG. NO.	CONDUCTOR RANGE	APPROXIMATE DIMENSIONS (IN.)				BOLT SIZE
			D	L	M	W	
LDN-2/0N	2	8 Sol. - 2/0 Str.	.44	2.31	2.81	.91	1/2
LDN-2/0N2	1	8 Sol. - 2/0 Str.	.44	2.38	3.13	1.38	
LDN-025N	2	6 Str. - 250 kcmil	.63	2.56	3.00	1.06	
LDN-025N2	1	6 Str. - 250 kcmil	.63	2.63	3.38	1.63	
LDN-035N	2	2 Sol. - 350 kcmil	.81	3.31	3.00	1.31	
LDN-050N	2	1/0 Sol. - 500 kcmil	.94	3.25	3.00	1.44	
LDN-075	2	350 - 750 kcmil	1.06	3.19	3.25	1.59	
LDN-100N	2	2/0 Sol. - 1000 kcmil	1.25	3.19	3.44	1.69	

For 1/4" to 3/4" Thick Bar

CATALOG NUMBER	FIG. NO.	CONDUCTOR RANGE	APPROXIMATE DIMENSIONS (IN.)				BOLT SIZE
			D	L	M	W	
LDN-2/0N2E	1	8 Sol. - 2/0 Str.	.44	2.88	3.13	1.38	1/2
LDN-025NE	2	6 Sol. - 250 kcmil	.63	3.06	3.00	1.06	
LDN-025N2E	1	6 Sol. - 250 kcmil	.63	3.06	3.38	1.63	
LDN-035NE	2	2 Sol. - 350 kcmil	.81	3.31	3.00	1.31	
LDN-050NE	2	1/0 Sol. - 500 kcmil	.94	3.75	3.00	1.44	
LDN-075E	2	350 - 750 kcmil	1.06	3.69	3.25	1.59	
LDN-100NE	2	2/0 Sol. - 1000 kcmil	1.25	4.06	3.44	1.69	
LD-200E	2	500 - 2000 kcmil	1.72	5.25	4.00	2.75	

"2" in suffix indicates two-way cable entrance