

ALUMINIUM SINGLE BARREL CONNECTORS – ONE HOLE MOUNT

- Made of high strength aluminium - 6061-T6
- Used for copper and or aluminium conductors.
- Electro - Tin plated for low contact resistance and protection against corrosion.
- East installation, no tools required.
- Connectors are re-usable.
- cULus 486B listed
- Rated 600 volts / 90°C

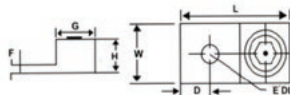

PART NO	CONDUCTOR RANGE		DIMENSION IN INCHES				
	MIN	MAX	L	W	D	E	BOLT HOLE
LA6	14 AWG	4 STR	1.10	0.50	0.23	0.09	1/4
LA2	14 AWG	2 STR	1.16	0.50	0.30	0.11	1/4
LA1/0	14 AWG	1/0 STR	1.46	0.63	0.44	0.19	1/4
LA2/0	14 AWG	2/0 STR	1.46	0.63	0.44	0.19	1/4
LA250	6 STR	250 KCMIL	2.00	0.86	0.50	0.25	5/16
LA300	6 STR	300 KCMIL	2.00	0.86	0.47	0.25	5/16
LA350	6 STR	350 KCMIL	2.25	1.25	0.50	0.25	3/8
LA500	4 STR	500 KCMIL	2.81	1.50	0.75	0.32	3/8
LA600	2 STR	600 KCMIL	3.19	1.50	0.81	0.44	3/8
LA800	300 KCMIL	800 KCMIL	3.37	1.75	0.87	0.50	5/8
LA1000	500 KCMIL	1000 KCMIL	3.37	1.75	0.87	0.50	5/8

ALUMINIUM TWO BARREL CONNECTORS – ONE HOLE MOUNT

- Made of high strength aluminium - 6061-T6
- Used for copper and or aluminium conductors.
- Electro - Tin plated for low contact resistance and protection against corrosion.
- East installation, no tools required.
- Connectors are re-usable.
- cULus 486B listed
- Rated 600 volts / 90°C

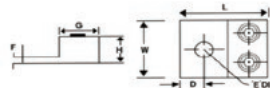

PART NO	CONDUCTOR RANGE		DIMENSION IN INCHES				
	MIN	MAX	L	W	D	E	BOLT HOLE
L2A0	14 AWG	1/0 STR	1.46	1.22	0.44	0.19	1/4
L2A2/0	14 AWG	2/0 STR	1.46	1.25	0.42	0.19	1/4
L2A250	6 STR	250 KCMIL	2.56	1.64	0.88	0.25	3/8
L2A350	6 STR	350 KCMIL	2.87	1.91	0.88	0.25	1/2
L2A600	2 STR	600 KCMIL	3.19	2.40	0.63	0.44	1/2
L2A800*	300 KCMIL	800 KCMIL	3.37	3.19	0.88	0.50	5/8
L2A1000*	500 KCMIL	1000 KCMIL	3.37	3.19	0.88	0.50	5/8

* Not UL Listed

Test conductor size installed in connector	Tightening torque, N·m (lbf·in)							
	Slotted head No. 10 and larger ^a				Hexagonal head – external drive socket wrench			
	Slot width – 1.2 mm (0.047 in) or less and slot length – 6.4 mm (1/4 in) or less		Slot width – over 1.2 mm (0.047 in) or slot length – over 6.4 mm (1/4 in)		Split-bolt connectors		Other connectors	
	AWG or kcmil	(mm ²)	A	B	A	B	A	B
30 – 10 (0.05 – 5.3)	1.7 (15)	2.3 (20)	2.8 (25)	4.0 (35)	7.3 (65)	9.0 (80)	6.8 (60)	8.5 (75)
8 (8.4)	2.3 (20)	2.8 (25)	3.4 (30)	4.5 (40)	7.3 (65)	9.0 (80)	6.8 (60)	8.5 (75)
6 – 4 (13.2 – 21.2)	2.8 (25)	4.0 (35)	4.0 (35)	5.1 (45)	15.3 (135)	18.6 (165)	10.2 (90)	12.4 (110)
3 (26.7)	2.8 (25)	4.0 (35)	4.5 (40)	5.6 (50)	25.4 (225)	31.1 (275)	14.1 (125)	16.9 (150)
2 (33.6)	3.4 (30)	4.5 (40)	4.5 (40)	5.6 (50)	25.4 (225)	31.1 (275)	14.1 (125)	16.9 (150)
1 (42.4)	–	–	4.5 (40)	5.6 (50)	25.4 (225)	31.1 (275)	14.1 (125)	16.9 (150)
1/0 – 2/0 (53.5 – 67.4)	–	–	4.5 (40)	5.6 (50)	35.6 (315)	43.5 (385)	18.9 (150)	20.3 (180)
3/0 – 4/0 (85.0 – 107.2)	–	–	4.5 (40)	5.6 (50)	45.2 (400)	56.5 (500)	22.6 (200)	28.2 (250)
250 – (127 – 177)	–	–	4.5 (40)	5.6 (50)	62.1 (550)	73.4 (650)	28.2 (250)	36.7 (325)
350	–	–	–	–	–	–	–	–
400 (203)	–	–	4.5 (40)	5.6 (50)	76.3 (675)	93.2 (825)	28.2 (250)	36.7 (325)

*LA350 - 375 lbs.

**L2A0 - Dependent on wire size used; Use the "Slot width - over 1.2 mm..." Column and the Column labeled "B"