

ALUMINUM PENN-CRIMPS® • TYPE BLUA

Crimp lugs for #6 stranded thru 1000 MCM copper or aluminum wire or cable

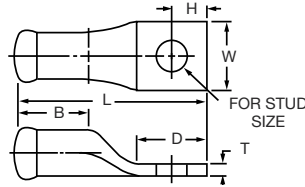

FIG. 1

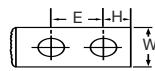

FIG. 2

Seamless, one piece, pure aluminum construction with tin plating assures maximum conductivity. Generous entrance chamfer provides easy cable insertion. The barrels are filled with Cual-Aid® and capped at factory to eliminate the need for separate application of Cual-Aid® to the conductor. Wire brushing of aluminum conductor is required. This assures a stable cool running joint. End of cable is protected from environmental hazards by completely closed transition.

Catalogue number and conductor size marked on every piece to insure positive identification.

Can be installed with existing crimping tools.

Colour coding conforms to industry requirements to insure proper connection/die selection and to provide for faster installation.

F

Part #	1 Cond. Range	Colour Code	Wire Dia. (in)	Stud Size	Fig. No.	Approximate Dimensions (in inches)							Crimping Tool Reference			
						L	B	D	E†	H	T	W	Alt. Tooling		Penn-Union	
													Burndy Index No.	T&B Die	PUC Dies	TDY-1 Pressure Setting
BLUA8S	8 Str.	Blue	.146	1/4	1	19/16	9/16	5/8	-	1/4	1/8	1/2	B-374	TBM-5	T-374*	2
BLUA6S BLUA6S2	6 Str.	Gray	.184	1/4 5/16	1 1	153/64	11/16	51/64	-	3/8	9/64	29/32	B-346		T-346*	
BLUA4S3 BLUA4S2	4 Str.	Green	.232	1/4 5/16	1 1	157/64	7/8	51/64	-	25/64	11/64	19/32	B-375	TBM-5	T-11/375	2
BLUA2S3 BLUA2S4 BLUA2S	2 Str.	Pink	.292	1/4 5/16 3/8	1 1 1	129/32 131/32 23/32	7/8	23/32 25/32 29/32	-	11/32 3/8 7/16	7/32	23/32	B-348		T-12/348	
BLUA1S1 BLUA1S3 BLUA1S BLUA1S2 BLUA1D1	1 Str.	Gold	.332	1/4 5/16 3/8 1/2 1/2	1 1 1 1 2	211/64 217/32 233/64 43/64	7/8	55/64 125/64 13/8 229/32	-	25/64 7/16 11/16 13/4	15/64	25/32	B-471	TBM-5	T-471*	2
BLUA1/0S2 BLUA1/0S3 BLUA1/0S BLUA1/0D1 BLUA1/0D2 BLUA1/0S1 BLUA1/0D3	1/0 Str.	Tan	.375	1/4 5/16 3/8 3/8 1/2 1/2	1 1 1 2 2 1 2	23/32 25/32 27/32 317/32 327/32 25/8 49/16	1	25/32 27/32 29/32 17/8 23/16 1 1/8 229/32	-	11/32 3/8 7/16 1 3/8 5/8 9/16 9/16	13/64	27/32	B-296		50	
BLUA2/0S4 BLUA2/0S5 BLUA2/0S1 BLUA2/0D2 BLUA2/0S BLUA2/0D	2/0 Str.	Olive	.419	1/4 5/16 3/8 3/8 1/2 1/2	1 1 1 2 1 2	2 1/4 25/16 25/8 33/8 25/8 421/32	13/32	25/32 27/32 1 17/8 15/32 229/32	-	11/32 3/8 5/8 1 3/8 9/16 9/16	1/4	15/16	B-297	54	T-297	
BLUA3/0S5 BLUA3/0S2 BLUA3/0D1 BLUA3/0S BLUA3/0D	3/0 Str.	Ruby	.470	5/16 3/8 3/8 1/2 1/2	1 1 2 1 2	219/32 213/16 329/32 229/32 415/16	1 1/4	27/32 1 1/16 17/8 15/32 229/32	-	3/8 7/16 1 3/8 9/16 9/16	9/32	11/16	B-467	60	T-467	5
BLUA4/0S3 BLUA4/0S5 BLUA4/0D2 BLUA4/0S BLUA4/0D BLUA4/0S4	4/0 Str.	White	.528	5/16 3/8 3/8 1/2 1/2 5/8	1 1 2 1 2 1	221/32 231/32 47/32 231/32 51/16 39/32	15/16	27/32 1 1/16 2 1/16 15/32 229/32 115/32	-	3/8 5/8 7/16 9/16 9/16 23/32	5/16	13/16	B-298	66	T-298	

• Not UL Listed.
 • Consult factory for availability of dies. Not available at this time.
 1 Concentric, Compressed and Compact and Compact Stranding. For other cable types see chart on page 109.
 † Note: On double hole lugs: Nema spacing #10 & 1/4" studs—5/8" centers, 3/8" studs—1" centers, 1/2" studs—1 3/4" centers.
 CSA approved with T&B, Burndy, Versa-Crimp, Huskie Tooling and Penn-Union Tools. See CSA File # LR23769-20, figure A5, appendix I.

Installation tools see page F-24

ALUMINUM PENN-CRIMPS® • TYPE BLUA

Continued from preceding page

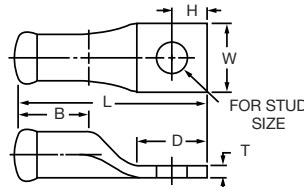

FIG. 1

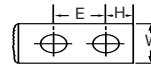

FIG. 2

BLUA LUGS ARE SUITABLE FOR USE AT VOLTAGES UP TO 35KV.

Part #	1 Cond. Range	Colour Code	Wire Dia. (in)	Stud Size	Fig. No.	Approximate Dimensions (in inches)							Crimping Tool Reference								
						L	B	D	E [†]	H	T	W	Alt. Tooling		Penn-Union						
													Burndy Index No.	T&B Die	PUC Dies	Pressure Setting TDY-1 TDY-U					
BLUA025S2 BLUA025D1 BLUA025S BLUA025D BLUA025S3	250 MCM	Red	.575	3/8 3/8 1/2 1/2 5/8	1 2 1 2 1	3 4 37/16 53/16 37/16	113/16	1 1/2 1 1/2 229/32 1 1/2	- 1 - 13/4 -	3/8 7/16 5/8 9/16 23/32	11/32	19/32	B-324	71	T-18/324	5	5				
BLUA030S2 BLUA030D1 BLUA030S1 BLUA030D BLUA030S	300 MCM	Blue	.634	3/8 3/8 1/2 1/2 5/8	1 2 1 2 1	37/16 415/32 311/16 55/16 321/32	1 1/2	1 1/4 23/8 1 1/2 55/16 115/32	- 1 - 13/4 -	3/8 7/16 11/16 9/16 23/32	3/8	13/8	B-470	76	T-470*						
BLUA035D1 BLUA035S1 BLUA035D BLUA035S	350 MCM	Brown	.682	3/8 1/2 1/2 5/8	2 1 2 1	47/16 37/8 59/32 37/8	15/8	21/16 1 1/2 229/32 1 1/2	1 - 13/4 -	7/16 11/16 9/16 11/16	3/8	117/32	B-299	87	T-20/299						
BLUA040D1 BLUA040S2 BLUA040D2 BLUA040S3 BLUA040D	400 MCM	Green	.728	3/8 1/2 1/2 5/8 5/8	2 1 2 1 2	53/32 417/32 613/32 427/32 61/4	113/16	21/16 1 1/2 33/8 113/16 37/32	1 - 13/4 - 13/4	7/16 11/16 3/4 7/8 23/32	7/16	15/8	B-472	94	T-22/472			7	7		
BLUA050D1 BLUA050S2 BLUA050D2 BLUA050S3 BLUA050D	500 MCM	Pink	.815	3/8 1/2 1/2 5/8 5/8	2 1 2 1 2	47/8 45/16 63/16 45/8 61/32	17/8	21/16 1 1/2 33/8 113/16 37/32	1 - 13/4 - 13/4	7/16 11/16 3/4 7/8 23/32	15/32	113/16	B-300	106	T-300						
BLUA060D1 BLUA060D2 BLUA060S1 BLUA060D	600 MCM	Black	.893	3/8 1/2 5/8 5/8	2 2 1 2	53/16 611/32 55/32 611/32	2	21/16 37/32 21/32 37/32	1 3/4 - 13/4	7/16 3/4 1 23/32	32/64	131/32	B-473	115	T-473						
BLUA075D1 BLUA075S1 BLUA075D	750 MCM	Red	.999	1/2 5/8 5/8	2 1 2	613/32 53/8 613/32	2 1/4	37/32 23/16 37/32	13/4 - 13/4	3/4 1 23/32	9/16	23/16	B-301	130	-					9	9
BLUA080D1 BLUA080S1 BLUA080D	800 MCM	Gray	1.031	1/2 5/8 5/8	2 1 2	71/8 613/32 71/8	25/16	37/32 21/2 37/32	13/4 - 13/4	3/4 1 23/32	19/32	21/4	B-474	140	-						
BLUA100D2 BLUA100S1 BLUA100D	1000 MCM	Brown	1.153	1/2 5/8 5/8	2 1 2	77/16 623/32 77/16	29/16	37/32 21/2 37/32	13/4 - 13/4	3/4 1 23/32	11/16	21/2	B-302	150	-						

Note: all items are UL Listed.
 * Consult factory for availability of dies. Not available at this time.
 † Concentric, Compressed and Compact and Compact Stranding. For other cable types see chart on page 109.
 † Note: On double hole lugs: Nema spacing #10 & 1/4" studs—5/8" centers, 3/8" studs—1" centers, 1/2" studs—1 3/8" centers.
 CSA approved with T&B, Burndy, Versa-Crimp, Huskie Tooling and Penn-Union Tools. See CSA File # LR23769-20, figure A5, appendix I.

Installation tools see page F-24

