

PRE-INSULATED HEAT SHRINKABLE TERMINALS AND SPLICES

Terminals are NOT Actual Size

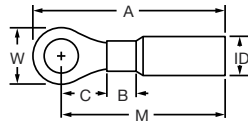
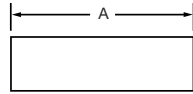

These heat shrinkable products provide a tough, environmentally sealed wire termination. These terminals and splices insulate and protect the electrical connections from wire pull-outs, abrasions and mechanical abuse. They also resist water, salt and other contaminants.

B



RING TERMINALS

BUTTED SEAM

Rated at 600V, 105°C

Part #	Wire Size	Stud Size	Colour Insul.	Approx. Dimen. in Inches			
				A	W	C	M
761648	16-14	8	Blue	1.150	.310	.144	.932
761649	16-14	10	Blue	1.275	.394	.225	1.035
761650	16-14	1/4	Blue	1.306	.474	.284	1.080
761651	16-14	3/8	Blue	1.548	.706	.414	1.207
761652	12-10	10	Yellow	1.417	.394	.225	1.035
761653	12-10	1/4	Yellow	1.467	.474	.284	1.080
761654	12-10	3/8	Yellow	1.829	.706	.414	1.207

For use with Copper Solid and Stranded Wire Only



FEMALE DISCONNECTS (FOR .250 X .032 TABS)

BUTTED SEAM

Rated at 600V, 105°C

Part #	Wire Size	Stud Size	Colour Insul.	Approx. Dimen. in Inches	
				A	W
761655	16-14		Blue	1.140	.253

For use with Copper Stranded Wire Only



MALE DISCONNECTS

BUTTED SEAM

Rated at 600V, 105°C

761656	16-14		Blue	1.227	.250
--------	-------	--	------	-------	------

For use with Copper Stranded Wire Only



BUTT CONNECTORS

SEAMLESS

Rated at 600V, 105°C

Part #	Copper Cond. Range	Stock Size (in)	Colour Code (ins)	Max. Insul. Diam.	A	ID
761244	22-18	.030	Red	.120	1.01	.055
761245	16-14	.030	Blue	.155	1.02	.090
761246	12-10	.040	Yellow	.215	1.01	.142

For use with Copper Solid and Stranded Wire Only

*Consult factory for other possible sizes and styles.

Add Suffix "B" for 500 pcs bulk pack
 Standard Pack – 25 pcs/pack

Installing Tools: RAT-HS, Heat Shrink Gun (see page E-7), or Butane Mini Torch (see page E-7)

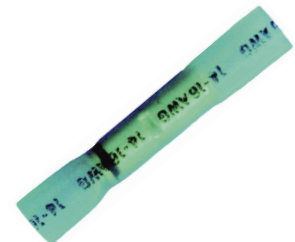

HOW TO SELECT THE PROPER CRIMP TERMINAL

Part # Example	R Tongue	4 Barrel Type	B Wire Range	6 Stud Size	S Special
-------------------	-------------	---------------------	--------------------	-------------------	--------------

Tongue

R = Ring	CFR = Female Disconnect, fully insulated	FLFR = Female Flag Disconnect	PG = Piggy Back Female/Male Disconnect/Tab
BS = Block Spade	FR = Female Disconnect	SF = Flanged Spade	
S = Spade	CM(X)T = Male Tab, fully insulated	LS = Locking Spade	
B = Butt Splice	MT = Male Tab	P = Parallel Splice	

Barrel Type 1 Butted Seam

Pure electrolytic copper, annealed, electro-tin plated for corrosion resistance, designed with deep internal serration for firm wire grip

2 Brazed Seam

Same as type 1, except with a brazed seam to ensure maximum strength of wire terminators

4 Vinyl Insulation

Same as type 1 with a NEMA colour-coded, funneled, vinyl insulating sleeve which when crimped, grips the wire insulation to avoid flexing at point of crimps. UL rated at 90°C, 600V

4N Nylon Insulation (No Brass Sleeve)

Same as type 1 with a colour-coded nylon insulating sleeve without brass sleeve. UL rated at 105°C, 600V

6 Nylon Insulation (With Brass Sleeve)

Same as type 1 with NEMA colour coded, nylon insulating sleeve or over a tin plated brass sleeve which offers maximum crimp strength where extreme vibration and flexing are encountered. UL rated at 105°C, 600V

7 Seamless Tube

Pure electrolytic copper, seamless, annealed and electro-tin plated for extra strength in a crimp

8 Nylon Insulation Seamless Tube

Same as type 7 with a nylon insulation for use where excessive vibration will be encountered.

9 High Temperature

Nickel-plated, cold rolled steel, butted seam terminals for temperatures up to 900°F

Wire Range

Code	A	B	C	E	F	G
Range (AWG)	22-18	16-14	12-10	8	6	4

Stud Size

Code	6	8	10	14		
Stud Size	#6	#8	#10	1/4"		
Code	56	38	50	110	187	250
Stud Size	5/16"	3/8"	1/2"	.110 NEMA Tab	.187 NEMA Tab	.250 NEMA Tab

Special

- Standard
- S Small/Narrow Tongue
- F Fully Insulated