

LOCK NUT
OPTIONAL
ADD: L

1/2 N.P.T.

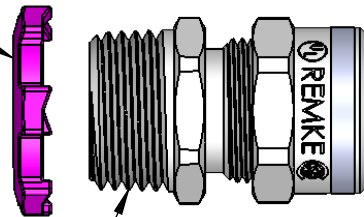

4.50 APPROX.

DOUBLE WEAVE

SINGLE WEAVE



ITEM NO.	PART NUMBER	DESCRIPTION	DESCRIPTION	QTY.
1	RSR-1000-B	BODY	ALUMINUM	1
2	SRB-004-SRB-005	BUSHING	NEOPRENE	1
3	RSR-000-ND	NUT	ALUMINUM	1
4	LN-50	LOCK NUT	ADD: L, C.R.S ZINC PLATED	1
5	R-005-D	MESH	STAINLESS WIRE	1

CATALOG NUMBER	SEALING RANGE	BODY BORE
RSR-1004-E	.187 - .250	.470
RSR-1005-E	.250 - .312	.470

REV.	DATE	CHANGE	UNLESS OTHERWISE SPECIFIED:	NAME	DATE	REMKE REMKE INDUSTRIES 310 CHADDICK DR, WHEELING, IL. 60090	
A	6/24/13	DRAWING RELEASED	DIMENSIONS ARE IN INCHES TOLERANCES: FRACTIONAL ± 1/64 ANGULAR: MACH ± 1° BEND ± 1° ONE PLACE DECIMAL ± .015 TWO PLACE DECIMAL ± .010 THREE PLACE DECIMAL ± .005 INTERPRET GEOMETRIC TOLERANCING PER: MATERIAL ALUMINUM FINISH DO NOT SCALE DRAWING	DRAWN JCN CHECKED ENG APPR. MFG APPR. Q.A.	6/13	TITLE: RSR-1004-1005-E SERIES	
				PROPRIETARY AND CONFIDENTIAL THE INFORMATION CONTAINED IN THIS DRAWING IS THE SOLE PROPERTY OF REMKE INDUSTRIES. ANY REPRODUCTION IN PART OR AS A WHOLE WITHOUT THE WRITTEN PERMISSION OF REMKE INDUSTRIES IS PROHIBITED.		SIZE A DWG. NO. RSR-1004-1005-E ASSEMBLY	SCALE: 1:1 SHEET 1 OF 1

5

↑

4

3

2

1