

Num	Date	By	Revision Note
1	06/01/07	jim	was .044

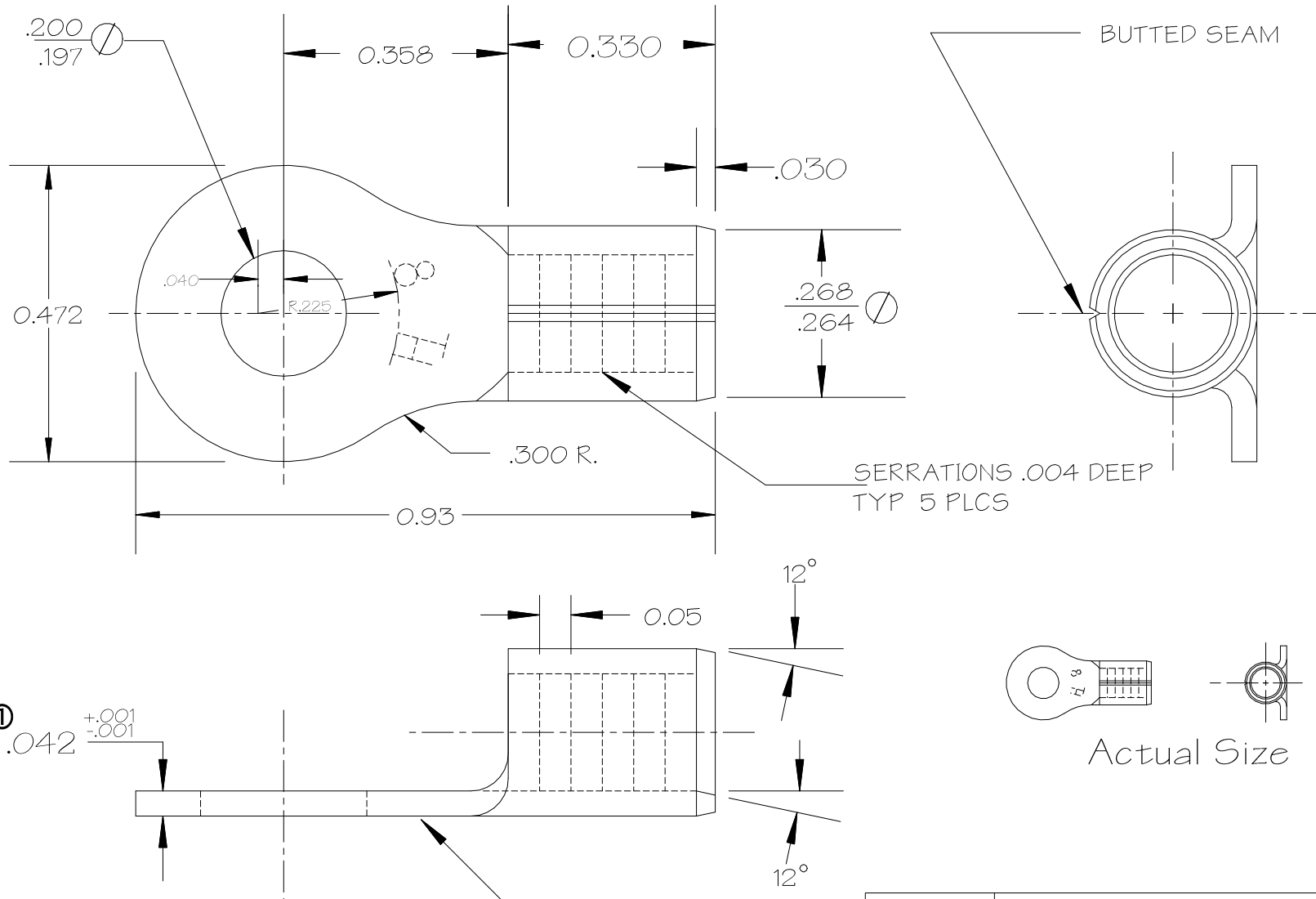

Notes:

1. Material: Commercial Mild Steel
ASTM Spec B-689
2. Finish: Nickel Plate
Fed QQ-N-290
.0002-.0004 Thick

NOTES

1. DO NOT SCALE PRINT.
2. BREAK ALL NON-CUTTING EDGES.
3. STAMP OR ETCH HTT, DET NO., MAT'L, & HEAT TREAT
4. GRIND AS SHOWN.

TOLERANCES UNLESS OTHERWISE SPECIFIED		H Hillsdale Terminal 250 Industrial Drive 2222 W. Moore Rd. Hillsdale, Michigan 49242	
.XXX	+/- .010	Title Uninsulated High Temp (900° F) 8 GA. #10 Stud Ring	
.XX	+/- .020	DRAWN BY J. Condon	DATE 08/27/95
.X	+/- .050	CHECKED BY	SCALE 4X
FRACTIONS	+/- 1/32	DIE NUMBER D-31	CAD DRAWING # 10610HT
ANGLES	+/- 0°30'	SHEET SIZE A	MATERIAL See Notes